



Ice dispensing machine Storage capacity up to 21 kg

Hotel	██
Restaurant	██
Fast food	██
Bar	██
Disco	██
Fish market	██
Supermarket	██
Medical & SPA	██
Industry	██

► Position n°



► Features & Plus

- Storage up to 21 kg
- AISI 304 SS Scotch Brite finishing 
- Dispensed ice: Pebbles ice with TM250 or 7g cube with VM350
- Inside plastic ABS FDA approved and AISI 304
- Insulated cabinet with polyurethane foam HCFC Free 
- RoHS Free 
- Electromechanical operation (no PC board) 
- No electric components in food zone
- Standard and special voltages
- Only 22" width
- Separated SS dispenser support (optional)
- Inox legs, can be fixed on the floor
- Suitable for "Counter Top" installation

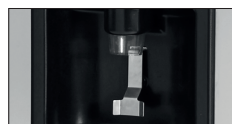

Ice dispenser



Inox legs, can be fixed on the floor



AISI 304 SS Scotch Brite finishing

► Available ice cube size

TM250
Pebble Ice

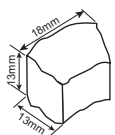

VM350
Ice Cube 7g

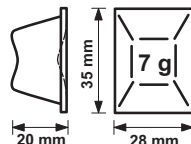

2 Years Warranty
subject to limitations

► Certifications available for this model



Ice dispensing machine

Storage capacity up to 21 kg

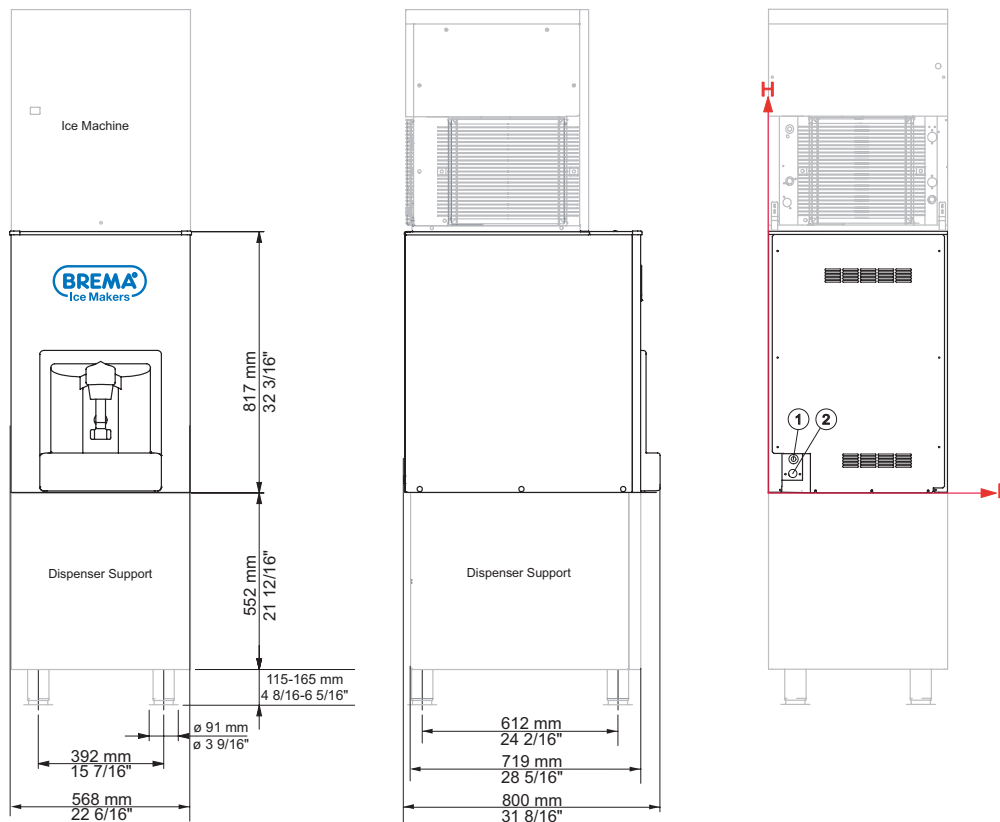

► Connections

All measures are referred to the rear bottom-left corner (L-H-Ø)

- ① Electrical connections: 44 mm / 1 12/16" - 40 mm / 1 9/16"
- ② Water out.: 120 mm / 4 12/16" - 215 mm / 8 7/16" - 3/4"

► Working conditions

- Location: **Indoor**

	Min	Max
Ambient temperature	+10° C / +50° F	+43° C / 110° F
Water temperature	+3° C / +37° F	+32° C / +90° F
Voltage	-10%	+10%

► Technical information

Store capacity, up to	21 kg / 46 lbs	Sizes (L-P-H mm)	568 - 800 - 817
Kind of cube	7g - 13x18x13	(L-P-H in)	22 6/16 - 31 8/16 - 32 3/16
Standard voltage	220-240 V ~ 50 Hz	Sizes with pack (L-P-H mm)	600 - 900 - 1030
Average power consumption	240 W	(L-P-H in)	23 5/16 - 19 5/16 - 25 3/16
Fuse	10 A	Net weight	58 kg / 128 lbs
Finish	AISI 304 stainless steel, scotch brite	Gross weight	66 kg / 146 lbs

All the technical information must be considered at the following conditions:

- Sizes without feet
- Ambient temperature +21° C
- Water temperature +15° C
- Average power consumption at +43° C (standard voltage)

Models and specifications are subject to change without notice

Rev. 01 - Issued November 2018